

Downstream Authority of the Quapaw Tribe of Oklahoma Regular Meeting
September 6, 2012

Meeting Called to Order: 10:10 am

ROLL CALL:	John Berrey, Chairman	Present
	Larry Ramsey, Secretary	Present
	Ranny McWatters, Treasurer	Present
	Marilyn Rogers, Member	Present
	Tamara Smiley, Member	Present

DECLARATION OF QUORUM: announced by Larry Ramsey

Prayer led by Ranny McWatters

Construction Updates

- Three week look ahead schedule
- See attached

Lobby

- Move current registration desk to temp location starting Oct 1
- Open new lobby Nov 15

Pool Bar

- Food Service drawing presented for review
- See attached

Terrazo

- Review color samples
- 10 different colors to be used
 - 1-4 – match existing
 - 5-7 – edge of “water” feature
 - 8-10 – Water
 - 8 – okay
 - 9 – needs less white
 - 10 – deeper blue
- 8-10 will be reworked and brought back for approval

Spa Entry

- Discussion on adding a “feature/inlay” to the flooring (lobby area)
- JCJ to create a sample for further review

Lamps

- 2 samples presented
 - Desk – consensus of the DDA to use this option
 - End table - like this option, but waiting on the desk sample before making final decision

Ariel Photo

- Trash Building – see attached
 - Gravel lot west of parking lot
 - Next to new warehouse
 - West of 690 road – preferred location
 - Would like to see facilities “yard” moved to the same location

Adjourn 12:13 pm

Meeting Minutes

Detailed, Grouped by Each Meeting and by 'Old Business' and 'New Business'

Downstream Hotel Expansion 12049 SE 110th Street Galena, KS 66739	Project # 3452 Tel: (620) 856-5600 Fax: (620) 856-5605	Manhattan Construction Company
--	--	---------------------------------------

Owner, Architect, Contractor Meeting 32

Date	Start	End	Next Meeting	Next Time	Prepared By	Company
9/6/2012	10:00 AM	12:00 PM	9/25/2012	10:00 AM	Ronnie Wood	Manhattan Construction Company

Purpose	Location	Next Location	General Notes
---------	----------	---------------	---------------

Attended By	Non-Attendees
-------------	---------------

Quapaw Tribe of Oklahoma - John Berrey
 Quapaw Tribe of Oklahoma - Larry Ramsey
 Quapaw Tribe of Oklahoma - Ranny Mcwatters
 Quapaw Tribe of Oklahoma - Tamara Smiley
 Quapaw Tribe of Oklahoma - Tena VanCleave
 Quapaw Tribe of Oklahoma - Tim Brown
 Quapaw Tribe of Oklahoma - Ernie Caruthers
 Quapaw Tribe of Oklahoma - Bob Moritz
 Quapaw Tribe of Oklahoma - Bob Bergquist
 Quapaw Tribe of Oklahoma - Marilyn Rogers
 Manhattan Construction Company - Mike Kanter
 Manhattan Construction Company - Ronnie Wood
 Manhattan Construction Company - Ryan Haynie
 Manhattan Construction Company - David Anderson
 Manhattan Construction Company - Jason Schafer
 JCJ Architecture - Grace Fabian
 JCJ Architecture - Kristina Ennis
 JCJ Architecture - Scott Celella
 Chris Roper Construction Services - Chris Roper
 Kinslow, Keith, & Todd - Amy Harrell

Item	Meeting	Item Description	Resp	Status	Due Date	Compl'd	Cls'd
------	---------	------------------	------	--------	----------	---------	-------

Old Business

Guest Room Furniture

013-003	8/8/2012	Upholstered furniture will arrive next week. Birch furniture will arrive the following week and they were set up as a vendor through the tribe last week.	Tim Brown (QUATRI); Chris Roper (CRCS)				No
	8/21/2012	The upholstered furniture was set up in the mock up rooms last week. The DDA will review before the mass order. Birch casegoods will arrive Thursday for both					

Meeting Minutes

Detailed, Grouped by Each Meeting and by 'Old Business' and 'New Business'

Item	Meeting	Item Description	Resp	Status	Due Date	Compl'd	Cls'd
Old Business							
		mock up rooms. There is a tour available of Birch Sept. 24th and delivery will begin Oct. 1st. The DDA may have a surplus inventory and donate items. All the standard room carpet has arrived and is being stored in a warehouse.					
		9/6/2012 Hotel furniture to begin arriving the second week of October.					
Kitchen Equipment							
024-001	8/21/2012	The kitchen hoods will arrive on Thursday, and the freezers next week.	Chris Roper (CRCS)				No
	9/6/2012	Hoods are currently being installed. Coolers and freezers install tomorrow. Next week ovens and equipment will arrive.					
Pool							
025-001	8/8/2012	JCJ to provide other light options, and possibly see if lights can be dimmable.					No
	8/21/2012	JCJ presented a recessed lighting option for the pool ceiling: Kirlin Vandal Resistant IP65 Rated sealed and gasketed VRR-12018. The wall sconce in three locations will be Ivalo Silvus 30" with an amber color.					
	9/6/2012	Lighting has been finalized. Underground piping is being completed in order to perform slab work.					
Spa							
025-002	8/8/2012	The Amerrec steam room and sauna are accepted. This is the same brand and style as the Walking Stick spa. Cut them loose to begin. Who has the waterproofing membrane?					No
	8/21/2012	Cold dunk options for the men's area will be presented by JCJ. The DDA requested a pre-shower storage shelf be added for hand towels and wash cloths near the robe hooks. Possibly look into adding a stainless bowl. Remove the tiles from the inside of the whirlpools. Only tile at the water line and leave the rest of the interior as an exposed stainless. It is sanitary. The whirlpool spa shop drawings are needed. These should have a capacity of 6-8 people.					
	9/6/2012	The cold dunk information is to be issued today from JCJ. Will this tank fit through a 3'-0" door?					
Mock Up Notes							
026-001	8/8/2012	Bulletins #12 and #20 should have captured everything necessary. The mock up on the hill has furniture and amenities shown. The boxes in a 3 bay suite will be ready and modeled for a review and furniture check next					Yes

Meeting Minutes

Detailed, Grouped by Each Meeting and by 'Old Business' and 'New Business'

Item	Meeting	Item Description	Resp	Status	Due Date	Compl'd	Cls'd
Old Business							
		Monday. 8/21/2012 The furniture is to be reviewed by the DDA in the mock up rooms. Amy and Grace will review the 3 bay rough in afterward.					
Elevator Roof Steel							
027-001	7/25/2012	Bulletin #15 Revision #2 issued from Chavez Grieves.					Yes
	8/8/2012	The design portion is complete and 80% of the steel is installed. The rest of the steel should arrive by the end of the week. The large crane should come down near the end of next week.					
	8/21/2012	The "H" frame arrived. Counterweight tube steel is to arrive later this week. Elevators #3 and #4 will arrive September 6th. Elevator #1 and #2 do not have a confirmed delivery date.					
Renovation Work							
027-002	8/8/2012	Review the new reception desk with Kathy and Chris Roper. The renovation work will be limited to 30 days.					No
	8/21/2012	The reception desk height has been adjusted. JCJ to look at an option of a low pass through on the concierge desk for luggage to pass through instead of having to walk around to get luggage.					
	9/6/2012	Still planning on October 1st for shutdown.					
Televisions							
028-001	8/8/2012	Chris Roper is to mark up a drawing today.					No
	8/21/2012	Chris presented proposed locations for the Lobby televisions and an ATM. These locations were reviewed and the drawing was given to JCJ for finalization.					
	9/6/2012	Televisions have been delivered.					
Signage							
028-002	8/8/2012	Another company is being brought in to look at the signage this week. The numbering system needs to be determined and designations for the spa created.					No
	8/21/2012	Proposals from several companies are being compiled and compared. Names are needed for the towers, lounge, grab and go, pool bar, board room.					
	9/6/2012	Preliminary pricing completed. MCC needs backing requirements for the swooshes and the Quapaw sign. Power is needed at each of these locations.					

Voice and Data

Meeting Minutes

Detailed, Grouped by Each Meeting and by 'Old Business' and 'New Business'

Item	Meeting	Item Description	Resp	Status	Due Date	Compl'd	Cls'd
Old Business							
028-003	7/25/2012	Three in hospitality suites.					Yes
	8/8/2012	Complete.					
	8/21/2012	This will be discussed during the 3 bay rough in review.					
Hardware							
028-004	7/25/2012	VING locks need to be brushed nickel finish.					No
	8/8/2012	VING lock sets are ordered. They should be sitting in a Dallas Warehouse.					
	8/21/2012	Done. Added at pool and MCC would like a meeting between the DCR locksmith, MCC and the hardware supplier.					
High Limits							
028-006	8/8/2012	JCJ to present material today. There is one column in the room which will receive a stone wrap. There will be no shelving on the side alcoves, but there will be space for art, most likely blankets. In the slot area the drum lights are to be removed. The new acoustical is to remain up high and ceiling features dropped lower. JCJ is to provide new carpet options.					No
	8/21/2012	Colored cove lighting to match the ceiling. The large rust colored swirled carpet is to be installed at a 45 degree angle to the room. (Option #3 in the presentation)					
	9/6/2012	Architecturally this area is designed. JCJ is to have a coordination call with M/E Engineering today. The 10' doors and hardware are ordered.					
Fitness Center							
028-009	8/8/2012	The back half of the room will be allocated for bag in a box soda dispensing equipment.					No
	8/21/2012	Bulletin #18 Revision 1 should complete this area.					
	9/6/2012	The fitness equipment company is currently being re-registered with the tribe.					
Indoor Pool Bar/Food Service							
028-010	8/8/2012	Pool bar design is not complete. The equipment is being redesigned. A new layout is being worked on now.					No
	8/21/2012	Food service vendor is working on the new drawings now.					
	9/6/2012	No update.					

Existing Buffalo Grill Remodel

Meeting Minutes

Detailed, Grouped by Each Meeting and by 'Old Business' and 'New Business'

Item	Meeting	Item Description	Resp	Status	Due Date	Compl'd	Cls'd
------	---------	------------------	------	--------	----------	---------	-------

Old Business

029-003	8/21/2012	As soon as new grill is open, then the remodel of the old Buffalo Grille will begin. MCC has performed a budgeting exercise base on current schematics and design overview.					No
	9/6/2012	This area is to turn into high limits slots.					

Item	Meeting	Item Description	Resp	Status	Due Date	Compl'd	Cls'd
------	---------	------------------	------	--------	----------	---------	-------

New Business

INNCOM System

032-001	9/6/2012	The desired INNCOM switch is 16 weeks to get. DDA decided to go with the glass, dimmer style switch.					No
---------	----------	--	--	--	--	--	----

Cc:	Company Name	Contact Name	Copies	Notes
-----	--------------	--------------	--------	-------

MANHATTAN CONSTRUCTION

DATE: 9/4/2012

PREPARED BY: Jason Schafer

THREE WEEK SCHEDULE

				DOWNSTREAM HOTEL EXPANSION																					
NO.	AREA	ACTIVITY DESCRIPTION	TIME OF DAY	SEPT																				REMARKS	NO.
				M	T	W	T	F	S	S	M	T	W	T	F	S	S	M	T	W	T	F	S	S	
				3	4	5	6	7	8	9	10	11	12	13	14	15	16	17	18	19	20	21	22	23	
1	Lower Level	Install Ceiling Grid	Day		X	X	X	X	X	X															
2		Build Elevator Shafts and Adjacent Walls	Day		X	X	X	X	X	X															
3		MEP ceiling rough-in	Day			X	X	X	X	X															
4		Tile Restrooms	Day						X		X	X	X	X	X										
5		Drop Ceiling Tile	Day								X	X	X	X	X	X		X	X	X	X	X	X		
6																									
7																									
8																									
9	Lower Level Kitchen	Install Tile	Day		X	X	X	X	X																
10		Hang FRP	Day					X	X																
11		Install Ceiling Grid	Day						X		X	X													
12		MEP ceiling rough-in	Day								X	X	X												
13		Install Kitchen Equipment	Day										X	X											
14		Hook Up Kitchen Equipment	Day										X	X	X	X									
15																									
16																									
17	Lobby Level	Complete Framing	Day		X																				
18		Sheetrock Walls	Day		X	X	X	X	X																
19		Tape & Bed Walls	Day		X	X	X	X	X		X	X	X	X											
20		Frame Hard Lids	Day		X	X	X	X	X		X	X	X	X											
21		MEP Rough In At Ceilings	Day		X	X	X	X	X		X	X	X	X	X										
22		Sheetrock hard lids	Day								X	X	X	X	X	X		X							
23		Tape And Bed Hard Lids	Day								X	X	X	X	X	X		X	X	X	X	X	X		
24		Prime Hard Lids	Day								X	X	X	X	X	X		X	X	X	X	X	X		
25		MEP TRIM Out Ceilings expect Wood Ceilings	Day										X	X	X	X		X	X	X	X	X	X		
26		Terrazzo	Day										X	X	X	X		X	X	X	X	X	X		
27																									
28																									
29	Buffalo Grill	Frame Remaining Walls	Day		X																				
30		Rough In Walls	Day		X	X	X	X																	
31		Sheetrock Walls	Day					X	X		X	X													
32		Frame Ceilings	Day						X		X	X	X												
33		MEP Rough In Ceilings	Day								X	X	X	X	X	X									
34		Sheetrock ceilings	Day												X	X		X	X	X					
35		Tape & Bed Walls & Ceilings	Day													X		X	X	X	X				
36		Install Interior Stone	Day													X		X	X	X	X	X	X		
37		Prime And Paint Ceilings	Day																	X	X	X	X		
38																									

MANHATTAN CONSTRUCTION

DATE: 9/4/2012

PREPARED BY: Jason Schafer

THREE WEEK SCHEDULE

				DOWNSTREAM HOTEL EXPANSION																					
NO.	AREA	ACTIVITY DESCRIPTION	TIME OF DAY	SEPT																				REMARKS	NO.
				M	T	W	T	F	S	S	M	T	W	T	F	S	S	M	T	W	T	F	S	S	
				3	4	5	6	7	8	9	10	11	12	13	14	15	16	17	18	19	20	21	22	23	
39																									39
40	SPA	Sheetrock Walls	Day		X																				40
41		Frame Ceilings	Day		X	X																			41
42		MEP Rough In Ceilings	Day		X	X	X	X																	42
43		Sheetrock / Tape And Bed Walls & Ceilings	Day				X	X	X																43
44		Prime And 1st Coat Ceilings	Day						X		X	X	X												44
45		Install Tile At Showers	Day								X	X	X	X	X	X									45
46		Install Sauna And Steam Rooms	Day													X		X	X	X	X	X			46
47																									47
48	Level 1	Install Tile	Day		X	X	X																		48
49		Prime And Paint Walls And Ceilings	Day		X	X	X																		49
50		Hang Wall Covering	Day			X	X	X	X																50
51		Install FCU's	Day		X	X	X																		51
52		Finish Sheetrock After FCU	Day				X	X	X																52
53		Install Millwork / Trim / Counter Tops	Day						X		X	X	X	X											53
54		Set Plumbing Fixtures	Day						X		X	X	X	X	X										54
55		MEP Trim Out	Day										X	X	X	X		X	X	X	X				55
56		Lay Carpet	Day										X	X	X	X		X	X	X	X	X	X		56
57																									57
58	Level 2	Install Tile	Day		X	X	X																		58
59		Prime And Paint Walls And Ceilings	Day		X	X	X																		59
60		Hang Wall Covering	Day			X	X	X	X																60
61		Install FCU's	Day		X	X	X																		61
62		Finish Sheetrock After FCU	Day				X	X	X																62
63		Install Millwork / Trim / Counter Tops	Day						X		X	X	X	X											63
64		Set Plumbing Fixtures	Day						X		X	X	X	X	X										64
65		MEP Trim Out	Day										X	X	X	X		X	X	X	X				65
66		Lay Carpet	Day										X	X	X	X		X	X	X	X	X	X		66
67																									67
68																									68
69																									69
70	Level 3	Tape & Bed Walls & Ceilings	Day		X	X																			70
71		Prime And Paint Walls And Ceilings	Day				X	X	X																71
72		Install Tile	Day					X	X		X	X	X	X	X										72
73		Install Millwork / Trim / Counter Tops	Day								X	X	X	X	X	X		X	X						73
74		Set Plumbing Fixtures	Day											X	X	X		X	X	X					74
75		Hang Wall Covering	Day												X	X		X	X	X					75
76		MEP Trim Out	Day																	X	X	X			76
77		Lay Carpet	Day																			X	X		77
78																									78
79																									79

MANHATTAN CONSTRUCTION

DATE: 9/4/2012

PREPARED BY: Jason Schafer

THREE WEEK SCHEDULE

				DOWNSTREAM HOTEL EXPANSION																					
NO.	AREA	ACTIVITY DESCRIPTION	TIME OF DAY	SEPT																				REMARKS	NO.
				M	T	W	T	F	S	S	M	T	W	T	F	S	S	M	T	W	T	F	S	S	
				3	4	5	6	7	8	9	10	11	12	13	14	15	16	17	18	19	20	21	22	23	
80	Level 4	MEP Rough In Ceilings	Day		X	X																			
81		Sheetrock Ceilings	Day			X	X	X																	
82		Tape & Bed Walls & Ceilings	Day				X	X	X		X														
83		Prime And Paint Walls And Ceilings	Day								X	X	X	X											
84		Install Tile	Day									X	X	X	X	X		X	X	X	X				
85		Hang Wall Covering	Day															X	X	X	X	X	X		
86		Install Millwork / Trim / Counter Tops	Day																		X	X	X		
87																									
88	Level 5	Famre Walls	Day		X																				
89		MEP In Wall Rough	Day		X	X																			
90		Sheetrock Walls	Day		X	X	X																		
91		Frame Hard Lids	Day			X	X	X																	
92		MEP Rough Ceilings	Day					X	X																
93		Sheetrock Ceilings	Day						X		X	X													
94		Tape & Bed Ceilings	Day								X	X	X	X											
95		Prime & Paint Walls & Ceilings	Day												X	X		X	X						
96		Hang Wall Covering	Day																	X	X	X	X		
97																									
98	Level 6	Famre Walls	Day		X																				
99		MEP In Wall Rough	Day		X	X																			
100		Sheetrock Walls	Day		X	X	X																		
101		Frame Hard Lids	Day			X	X	X																	
102		MEP Rough Ceilings	Day					X	X																
103		Sheetrock Ceilings	Day						X		X	X													
104		Tape & Bed Ceilings	Day								X	X	X	X											
105		Prime & Paint Walls & Ceilings	Day												X	X		X	X						
106		Hang Wall Covering	Day												X	X				X	X	X	X		
107																									
108																									
109	FAÇADE TOWER	Efis Finish Coat	Day		X	X	X	X	X																
110		Install Windows	Day		X	X	X	X	X		X	X	X	X											
111																									
112																									
113	FAÇADE (LOBBY)	Install South Windows	Day		C	A	U	L	K		E	X	T	E	R	I	O	R							
114		Install Storefront	Day		X	X	X	X	X																
115		Install Stone & Precast	Day		X	X	X	X	X																
116																									
117																									
118	CONNECTOR	Prep And Pour SOG West End	Day		X	X																			
119		Frame / Sheath Exterior	Day				X	X	X																
120		Install Roofing	Day						X		X														
121																									
122																									

MANHATTAN CONSTRUCTION

DATE: 9/4/2012

PREPARED BY: Jason Schafer

THREE WEEK SCHEDULE

				DOWNSTREAM HOTEL EXPANSION																					
NO.	AREA	ACTIVITY DESCRIPTION	TIME OF DAY	SEPT																				REMARKS	NO.
				M	T	W	T	F	S	S	M	T	W	T	F	S	S	M	T	W	T	F	S	S	
				3	4	5	6	7	8	9	10	11	12	13	14	15	16	17	18	19	20	21	22	23	
123																									
124	Roof	Roof Smalll Lower Areas	Day		X	X																			
125		Expansions Joint	Day			X	X																		
126		Finish Detail At All Roofs	Day					X	X		X	X	X	X	X	X									
127																									
128	STAIRS	Install Stair 3	Day		X																				
129		Install Temp Rails Stair 3	Day		X																				
130		Pour Stair 3	Day				X																		
131		Frame / Rough All Stairs	Day		X	X	X	X	X																
132																									
	POOL	Install Underslab Pipes	Day		X	X																			
134		Strip Pump Pits	Day		X	X																			
135		Other Trades Remaining Underslab Rough	Day		X	X	X	X	X		X	X													
136		Install Air Recovery System	Day		X	X	X	X	X		X	X													
137																									
138	VFCU	Set VCFU's	Day			X																			
139		Hook Up VFCU's	Day		X	X	X	X	X																
140																									
141	Elevators 3 & 4	Build Shaft Walls On 6 and Penthouse	Day		X																				
142		Build Elevator Equipment Room	Day		X																				
143		Fire Spray	Day		X																				
144		Elevator Install	Day				X	X	X		X	X	X	X	X	X		X	X	X					
145																									
146	SITE	Remove Boxes	Day																						
147		Underground Eleltrical	Day		X	X	X	X	X																
148		Site Grading	Day		X	X	X	X	X																
149		Site Utilities	Day		X	X	X	X	X																
150		Begin Site Concrete	Day								X	X	X	X	X	X		X	X	X	X	X	X		
151																									
152	Misc Items	Composite Clean Up Crew	ALL		X							X							X						
153		Sign Off Sheet	ALL																						
154		Veritcle FCU'S	Allens		X	X	X	X	X																
155		Set Cooling Tower	Allens																						
156		Conditioned Air Available	Allens		X	X																			
157		Bulletin Log	ALL																						
158		Crane Demobilize	Bennett				X	X																	
159		Lifts Out Of Basement	ALL																						
160		Rain Coming	ALL			X		X																	
161																									

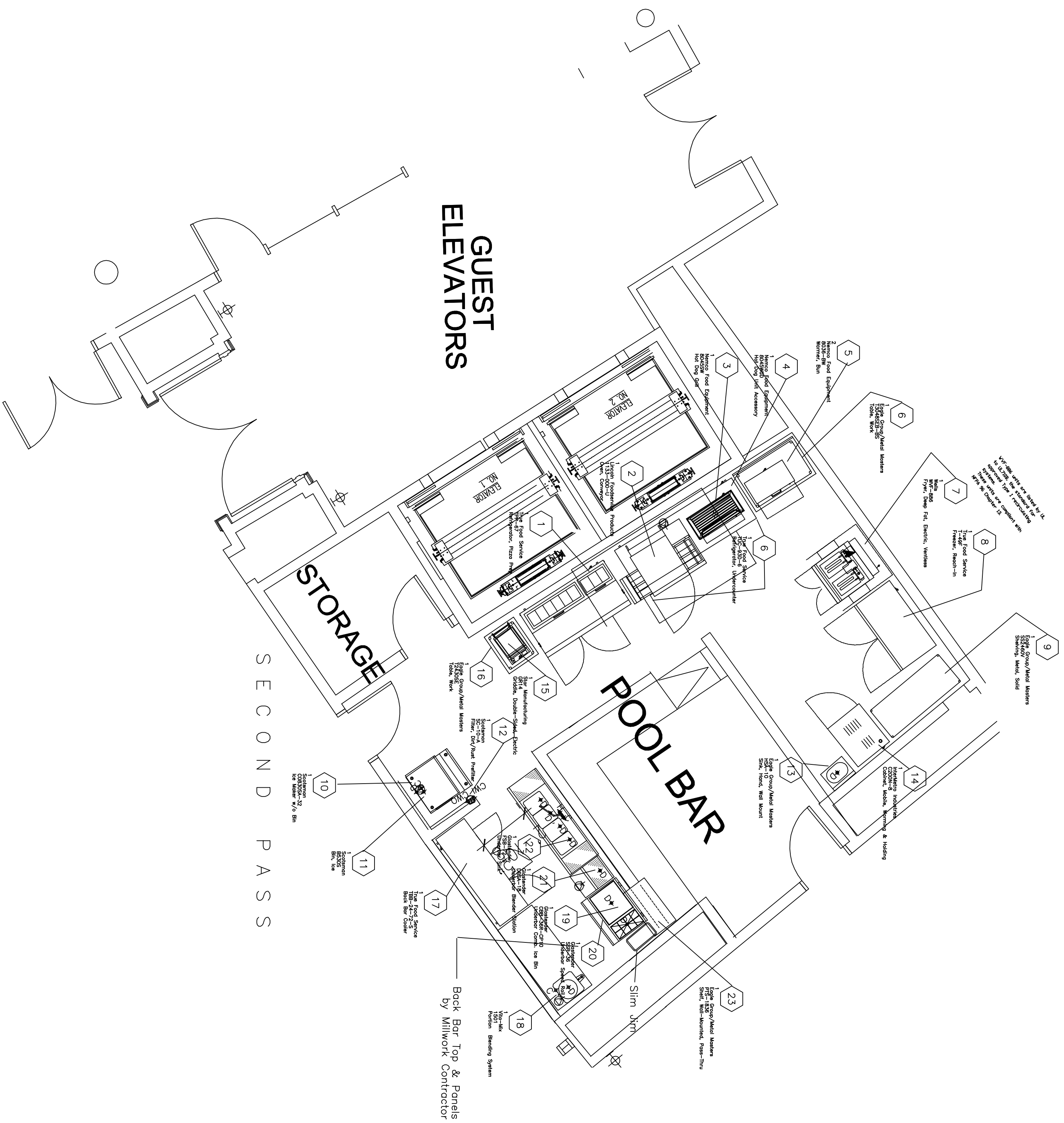

EQUIPMENT SCHEDULE												
Item No	Qty	Equipment Category	Manufacturer	Model Number	Equipment Remarks	Amps	KW	HP	Volts	Phase	Cycle	Direct Plug
1	1	Refrigerator, Pizza Prep	True Food Service	TPP-67		8.6		0.33	120	1	60	X
2	1	Oven, Conveyor	Lincoln Foodservice Products	1133-000-U		25.0	10.0		120/240	3	60	X
3	1	Hot, Dog Grill	Nemco	8045SW		13.0	11.5		120	1	60	X
4	1	Hot, Dog Unit Accessory	Nemco	8045MGD					120	1	60	X
5	2	Wormer, Drawer Type	Nemco	8036BW		7.7	0.9		120	1	60	X
6	1	Refrigerator, Undercounter	True Food Service	TUC-93D-6		9.7		0.5	115	1	60	X
6	1	Table, Work	Eagle Group/Metal Masters	130485EB-B5								
7	1	Fryer, Deep Fat, Electric, Ventless	Wells	WFF-886		33.0	12.0		208	3	60	X
8	1	Freezer, Reach-In	True Food Service	T-49F		12.5		0.75	115	1	60	X
9	1	Shaving, Metal, Solid	Eagle Group/Metal Masters	SS246DV								
10	1	Hot Maker w/s Bin	Scotman	CO8303A-32		11.9			208	1	60	X
11	1	Bin, Ice	Scotman	B-5305								
12	1	Filter System, Iceemaker	SC-10A									
13	1	Sink, Hand, Wall Mount	Eagle Group/Metal Masters	HS4-10								
14	1	Cabinet, Mobile, Warming & Holding	Infernetto Industries	C200N-8		16.0	2.0		120	1	60	X
15	1	Groddle, Double-Sided, Electric	Slar Manufacturing	GR14		15.0	1.8		120	1	60	X
16	1	Table, Work	Eagle Group/Metal Masters	124305E								
17	1	Back Bar Cooler	True Food Service	TBB-24-72-S		5.2		0.2	115	1	60	X
18	1	Portion Blending System	Vinci-Kix	1501		12.0						
19	1	Underbar Cocktail Unit	Graetender	CRB-36R CP10				2.0	115	1	60	X
20	1	Underbar Speed Rail	Graetender	SSR-36								
21	1	Underbar Blender Station	Graetender	DBSA-18								
22	1	Underbar Sink	Graetender	F5B-72-S								
23	1	Pass Thru Window-Shaft	Eagle Group/Metal Masters	PIS-1836								

SECOND PASSES

1. These documents are intended to be used in association with Architectural and Engineering drawings and are not in of themselves a complete set. These drawings are as accurate as possible and do not contain discrepancies between these drawings and actual field conditions.
2. These drawings only show requirements for the equipment being supplied by B & J, please refer to Engineering and Architectural drawings for all other general and specific purpose electrical connections or plumbing connections that are not required by Food Service Equipment.
3. This drawing is provided for placement of equipment only. B & J Food Service Equipment does not provide or furnish any plumbing, electrical or HVAC services or connections, unless stated herein.

8/21	Revised per Phone Conference	WE
7/26	Revised per Phone Conference	WE
DATE	REVISIONS	BY

PROJECT
DOWNSTREAM CASINO
POOL BAR/KITCHEN
Hotel Expansion Project
Quapaw, Oklahoma

DATE	07-25-12
SCALE	1/4"=1'-0"
DRAWN BY	WE

B & J Food Service Equipment
Contract Department
236 North 7th Street
Kansas City, KS 66101
(913) 621-6165 / Fax (913) 621-5520

DWG NO.
1562 A

PROJECT CODE
217440

SHEET NO.
K-1

